



# OWNER'S MANUAL

# WASHING

# MACHINE



**Before beginning installation, read these instructions carefully. This will simplify installation and ensure that the product is installed correctly and safely. Leave these instructions near the product after installation for future reference.**

WD1409NPW  
WD1409NPE



MFL69040435

[www.lg.com](http://www.lg.com)

# TABLE OF CONTENTS

This manual is produced for a group of products and may contain images or content different from the model you purchased.

This manual is subject to revision by the manufacturer.

|   |           |
|---|-----------|
| <b>SAFETY INSTRUCTIONS .....</b>              | <b>03</b> |
| Important Safety Instructions.....            | 05        |
| <b>INSTALLATION.....</b>                      | <b>08</b> |
| Specifications .....                          | 08        |
| Accessories .....                             | 08        |
| Installation Place Requirements .....         | 09        |
| Unpacking and Removing Shipping Bolts .....   | 10        |
| Using Non-Skid Pads (Optional).....           | 11        |
| Wooden Floors (Suspended Floors).....         | 11        |
| Leveling the Washing Machine.....             | 12        |
| Connecting Inlet Hose .....                   | 12        |
| Installation of Drain Hose .....              | 15        |
| Electrical Connections (In the UK Only) ..... | 15        |
| <b>OPERATION .....</b>                        | <b>16</b> |
| Using the Washing Machine.....                | 16        |
| Sorting laundry .....                         | 17        |
| Adding Cleaning Products .....                | 18        |
| Control Panel.....                            | 20        |
| Programme Table .....                         | 21        |
| Option Cycle .....                            | 25        |
| Using Smart Function (Optional) .....         | 28        |
| <b>MAINTENANCE .....</b>                      | <b>29</b> |
| Cleaning your Washing Machine .....           | 29        |
| Cleaning the Water Inlet Filter .....         | 29        |
| Cleaning the Drain Pump Filter .....          | 30        |
| Cleaning the Dispenser Drawer.....            | 31        |
| Tub Clean (Optional) .....                    | 31        |
| Caution on Freezing During Winter .....       | 32        |
| Using the Smart Diagnosis™ Function .....     | 34        |
| <b>TROUBLESHOOTING .....</b>                  | <b>35</b> |
| Diagnosing Problems .....                     | 35        |
| Error Messages .....                          | 37        |

## SAFETY INSTRUCTIONS

The following safety guidelines are intended to prevent unforeseen risks or damage from unsafe or incorrect operation of the product.

The guidelines are separated into 'WARNING' and 'CAUTION' as described below.

 This symbol is displayed to indicate matters and operations that can cause risk. Read the part with this symbol carefully and follow the instructions in order to avoid risk.

 **WARNING** - This indicates that the failure to follow the instructions can cause serious injury or death.

 **CAUTION** - This indicates that the failure to follow the instructions can cause the minor injury or damage the product.

### **WARNING**

To reduce the risk of fire, electric shock, or injury to persons when using your product, basic safety precautions should be followed, including the following.

## CHILDREN IN THE HOUSEHOLD

This appliance is not intended for use by persons (including children) with reduced physical, sensory or mental capabilities, or lack of experience and knowledge, unless they have been given supervision or instruction concerning use of the appliance by a person responsible for their safety. Children should be supervised to ensure that they do not play with the appliance.

### **For use in Europe:**

This appliance can be used by children aged from 8 years and above and persons with reduced physical, sensory or mental capabilities or lack of experience and knowledge if they have been given supervision or instruction concerning use of the appliance in a safe way and understand the hazards involved. Children shall not play with the appliance. Cleaning and user maintenance shall not be made by children without supervision. Children of less than 3 years should be kept away unless continuously supervised.

## GROUNDING REQUIREMENTS

### **WARNING**

**For your safety, the information in this manual must be followed to minimize the risk of fire, explosion, or electric shock, or to prevent property damage, injury to persons, or death.**

- This appliance must be grounded. In the event of malfunction or breakdown, grounding will reduce the risk of electric shock by providing a path of least resistance for electric current.
- This appliance is equipped with a cord having an equipment-grounding conductor and grounding plug. The plug must be plugged into an appropriate outlet that is properly installed and grounded in accordance with all local codes and ordinances.
- Improper connection of the equipment-grounding conductor can result in risk of electric shock. Check with a qualified electrician or service person if you are in doubt as to whether the appliance is properly grounded.
- Do not modify the plug provided with the appliance. If it does not fit the outlet, have a proper outlet installed by a qualified electrician.

## DISPOSAL OF YOUR OLD APPLIANCE



1. All electrical and electronic products should be disposed of separately from the municipal waste stream via designated collection facilities appointed by the government or the local authorities.
2. The correct disposal of your old appliance will help prevent potential negative consequences for the environment and human health.
3. For more detailed information about disposal of your old appliance, please contact your city office, waste disposal service or the shop where you purchased the product.

## Important Safety Instructions

### **WARNING**

To reduce the risk of fire, electric shock, or injury to persons when using your product, basic safety precautions should be followed, including the following.

### Installation

- Never attempt to operate this appliance if it is damaged, malfunctioning, partially disassembled, or has missing or broken parts, including a damaged cord or plug. It can cause electric shock or injury.
- This appliance is heavy. Two or more people may be needed to install and move the appliance. Failure to do so can result in injury.
- Do not store or install this appliance where it will be exposed to temperatures below freezing or exposed to outdoor weather conditions such as wind rain and direct sunlight. Failure to do so can result in leakage, fire or electric shock.
- Tighten the drain hose to avoid separation. Splashing of water may cause electric shock.
- If the supply cord is damaged, it must be replaced by the manufacturer or its service agents or similarly qualified person in order to avoid a hazard.
- The appliance must not be installed behind a lockable door, a sliding door or a door with a hinge on the opposite side to that of the tumble dryer, in such a way that a full opening of the tumble dryer door is restricted.

### Operation

- Only an authorized repair person from an LG Electronics service centre should disassemble, repair, or modify the product. Improper service may cause injury, electric shock or fire.
- Do not spray the water inside or outside the product to clean it. Water can damage the insulation, causing electric shock or fire.
- Keep the area underneath and around your appliances free of combustible materials such as lint, paper, rags, chemicals, etc. Improper use can cause fire or explosion.
- Do not put living animals, such as pets into the product. It may cause injury.
- Do not leave this appliance door open. Children may hang on the door or crawl inside the appliance, causing damage or injury.
- Do not wash rugs, mats, shoes or pet blankets, or any other items other than clothes or sheets, in this machine.

- Never reach into this appliance while it is operating. Wait until the drum has completely stopped. Failure to do so may result in injury.
- Do not load any laundry articles that have been cleaned in, washed in, soaked in, or spotted with combustible or explosive substances (such as wax, oil, paint, gasoline, degreasers, drycleaning solvents, kerosene, vegetable oil, cooking oil, etc.). Improper use can cause fire or an explosion.
- In case of a water leak, stop using the product and contact an LG Electronics service centre. Unplug the unit from the power and turn off the taps in the event of a water leak.
- Do not lean or push down on the door whilst it is open. Doing so can damage the door and cause the machine to topple over causing injury.
- Use new hose-sets supplied with the appliance. Reusing old hoses can cause a water leak and subsequent property damage.
- Do not touch the door during steam cycles, drying or high-temperature washing on models with these features. The door surface can become very hot. Allow the door lock to release before opening the door. Failure to do so may result in injury.
- Do not use inflammable gas and combustible substances (benzene, gasoline, thinner, petroleum, alcohol, etc.) around the product. It may cause explosion or fire.
- If the drain hose or inlet hose is frozen during winter, use it only after thawing. Freezing may cause fire or electric shock, and frozen parts may cause product malfunction or reduction in product life span.
- Keep all washing detergents, softener and bleach away from children. These products contain poisonous materials.
- Do not plug multiple products into multiple socket-outlets or extension cords. This can cause fire.
- Remove the power plug when you clean the product. Not removing the plug may result in electric shock or injury.
- Do not touch the power plug with wet hands. It can cause the electric shock or injury.
- When pulling out the power plug from an outlet, hold the power plug, not the cable. Damage of the cable can cause the electric shock or injury.
- Do not bend the power cable excessively or place a heavy object on top of it. Damage of the power cable can cause electric shock or fire.

- This appliance must only be used for domestic household purposes and should not be used in mobile applications.

## **Disposal**

- Before discarding an old appliance, unplug it. Render the plug useless. Cut off the cable directly behind the appliance to prevent misuse.
- Dispose of the packaging material (such as vinyl and styrofoam) away from children. The packaging material can suffocate a child.
- Remove the door to the washing compartment before this appliance is removed from service or discarded to avoid the danger of children or small animals getting trapped inside. Failure to do so can result in serious injury to persons or death.

# INSTALLATION

## Specifications

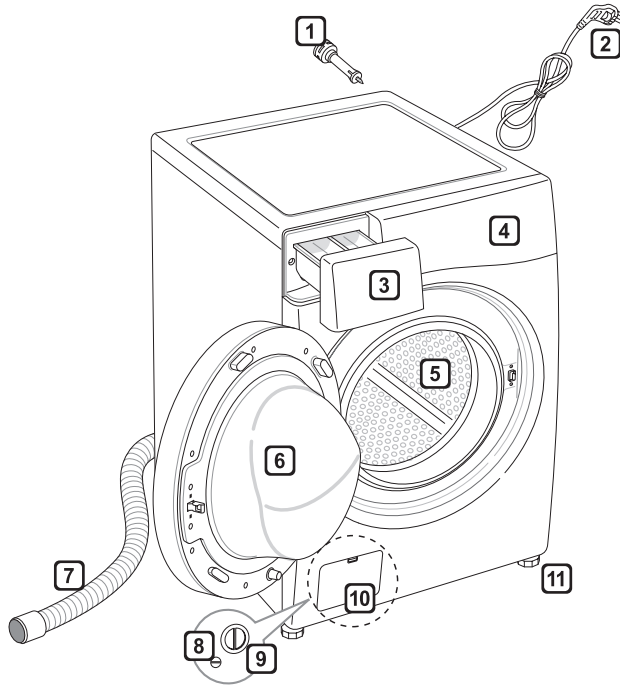

- 1** Transit bolts  
(Must be removed before use)
- 2** Power plug
- 3** Drawer
- 4** Control panel
- 5** Drum
- 6** Door
- 7** Drain hose
- 8** Drain plug
- 9** Drain pump filter
- 10** Cover cap (Location may vary depending on products)
- 11** Adjustable feet

- Power supply : 220–240 V~, 50 Hz
- Size : 600 mm (W) X 640 mm (D) X 850 mm (H)
- Product weight : 68 kg
- Wash Capacity : 9 kg
- Permissible water pressure : 0.1 - 0.8 MPa (1.0 - 8.0 kgf / cm<sup>2</sup>)
- The external hot water supply **MUST NOT** exceed 65 °C
- Permissible cold water temperature : 4 - 25 °C
- No further backflow protection required for connection to the water supply.
- The appearance and specifications may be varied without notice to improve the units quality.
- Specifications subject to change by manufacturer.

## Accessories

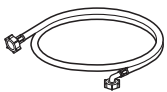

Inlet hose (1EA)  
(Option: Hot (1EA))



Spanner

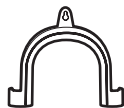

Elbow Bracket  
(for securing drain hose)



Anti-slip sheets (2EA)  
(Optional in some countries only)



Caps for covering shipping bolt holes



Tie strap  
(Optional in some countries only)



## Installation Place Requirements

### Location

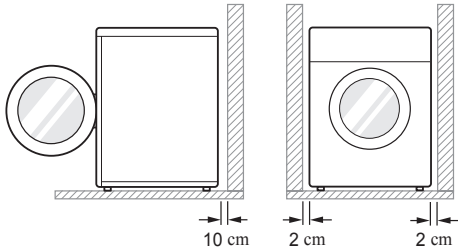

**Level floor :** Allowable slope under the entire washing machine is 1°.

**Power outlet :** Must be within 1.5 meters of either side of the location of the washing machine.

- Do not overload the outlet with more than one appliance.

**Additional Clearance :** For the wall, 10 cm: rear  
/2 cm: right & left side

- Do not place or store laundry products on top of the washing machine at any time.
- These products may damage the finish or controls.

### Positioning

- Install the washing machine on a flat hard floor.
- Make sure that air circulation around the washing machine is not impeded by carpets, rugs, etc.
- Never try to correct any unevenness in the floor with pieces of wood, cardboard or similar materials under the washing machine.
- If it is impossible to avoid positioning the washing machine next to a gas cooker or other heat sources, an insulation (85x60 cm) panel covered with aluminum foil on the side facing the cooker or heat source must be inserted between the two appliances.

- Do not install your washing machine in rooms where freezing temperatures may occur. Frozen hoses may burst under pressure. The reliability of the electronic control unit may be impaired at temperatures below freezing point.
- Please ensure that when the washing machine is installed, it is easily accessible for an engineer in the event of a breakdown.
- With the washing machine installed, adjust all four feet using the transit bolt spanner provided to ensure the appliance is stable, and a clearance of approximately 20 mm is left between the top of the washing machine and the underside of any work-top.
- This equipment is not designed for maritime use or for use in mobile installations such as caravans, aircraft etc.

### Electrical Connection

- Do not use an extension cord or double adapter.
- Always unplug the washing machine and turn off the water supply after use.
- Connect the washing machine to an earthed socket in accordance with current wiring regulations.
- The washing machine must be positioned so that the plug is easily accessible.
- Repairs to the washing machine must only be carried out by qualified personnel. Repairs carried out by inexperienced persons may cause injury or serious malfunctioning. Contact your local service centre.
- If the washing machine is delivered in winter and temperatures are below freezing, place the washing machine at room temperature for a few hours before putting it into operation.

## Unpacking and Removing Shipping Bolts (Transit bolts)

### 1 Lift the washing machine off the foam base.

- After removing the carton and shipping material, lift the washing machine off the foam base. Make sure the tub support comes off with the base and is not stuck to the bottom of the washing machine.
- If you must lay the washing machine down to remove the carton base, always protect the side of the washing machine and lay it carefully on its side. **DO NOT** lay the washing machine on its front or back.

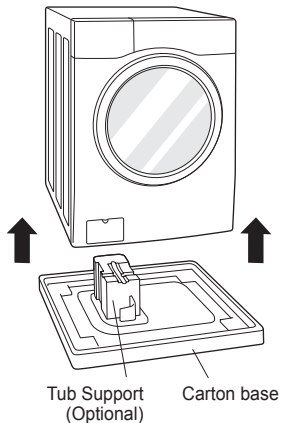

### 2 Remove the bolt assemblies.

- Starting with the bottom two shipping bolts, use the spanner (included) to fully loosen all shipping bolts by turning them counterclockwise. Remove the bolt assemblies by wiggling them slightly while pulling them out.

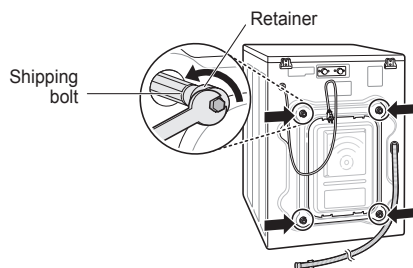

### 3 Install the hole caps.

- Locate the hole caps included in the accessory pack and install them in the shipping bolt holes.

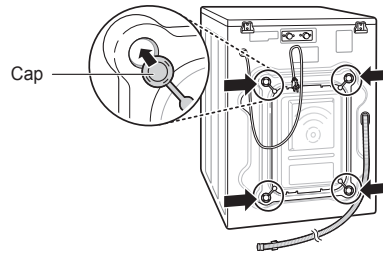

### NOTE

- Save the bolt assemblies for future use. To prevent damage to internal components, **DO NOT** transport the washing machine without reinstalling the shipping bolts.
- Failure to remove shipping bolts and retainers during installation, may cause severe vibration and noise, which can lead to permanent damage to the washing machine. The cord is secured to the back of the washing machine with a shipping bolt to help prevent operation with shipping bolts in place.

## Using Non-Skid Pads (Optional)

If you install the washing machine on a slippery surface, it may move because of excessive vibration. Incorrect leveling may cause malfunction through noise and vibration. If this occurs, install the non-skid pads under the leveling feet and adjust the level.

- 1 Clean the floor to attach the non-skid pads.
  - Use a dry rag to remove and clean foreign objects and moisture. If moisture remains, the non-skid pads may slip.
- 2 Adjust the level after placing the washing machine in the installation area.
- 3 Place the adhesive side of the non-skid pad on the floor.
  - It is most effective to install the non-skid pads under the front legs. If it is difficult to place the pads under the front legs, place them under the back legs.

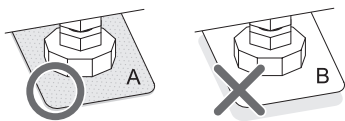
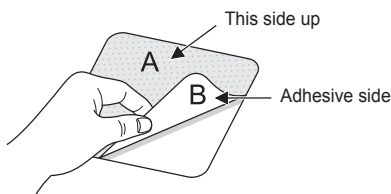

- 4 Ensure the washing machine is level.
  - Push or rock the top diagonal edges of the washing machine firmly to make sure that the washing machine does not rock. If the washing machine rocks, level the washing machine again.

## Wooden Floors (Suspended Floors)

- Wooden floors are particularly susceptible to vibration.
- To reduce vibration we recommend you place rubber cups at least 15 mm thick under each foot of the washing machine, secured to at least two floor beams with screws.

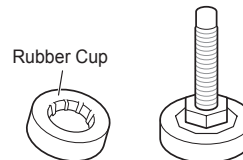

- If possible install the washing machine in one of the corners of the room, where the floor is more stable.
- Fit the rubber cups to reduce vibration.
- You can obtain rubber cups (p/no.4620ER4002B) from an LG Service Centre.

### NOTE

- Proper placement and leveling of the washing machine will ensure long, regular, and reliable operation.
- The washing machine must be 100% horizontal and stand firmly in position.
- It must not 'Seesaw' across corners under the load.
- The installation surface must be clean, free from floor wax and other lubricant coatings.
- Do not let the feet of the washing machine get wet. Failure to do so may cause vibration or noise.

## Leveling the Washing Machine

If the floor is uneven, turn the adjustable feet as required (Do not insert pieces of wood etc. under the feet). Make sure that all four feet are stable and resting on the floor and then check that the appliance is perfectly level (Use a spirit level).

- Once the washing machine is level, tighten the lock nuts up towards the base of the washing machine. All lock nuts must be tightened.

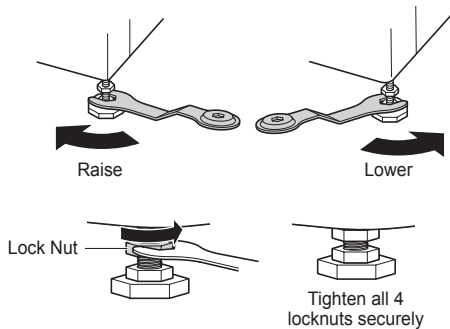

- **Diagonal Check**

When pushing down the edges of the washing machine top plate diagonally, the washing machine should not move up and down at all (Check both directions). If the washing machine rocks when pushing the machine top plate diagonally, adjust the feet again.

### NOTE

- Timber or suspended type flooring may contribute to excessive vibration and unbalance.
- Do Not install the washer on a raised platform, plinth or stand, unless it is manufactured and specified for its purpose by LG Electronics.

## Connecting Inlet Hose

- Water supply pressure must be between 0.1 MPa and 0.8 MPa (1.0–8.0 kgf/cm<sup>2</sup>).
- Do not strip or crossthread when connecting inlet hose to the valve.
- If the water supply pressure is more than 0.8 MPa, a decompression device should be installed.
- Periodically check the condition of the hose and replace the hose if necessary.

## Checking the Rubber Seal on the Inlet Hose

Two rubber seals are supplied with the water inlet hoses. They are used for preventing water leaks. Make sure they are present when connecting the inlet hoses. Firmly hand tighten the inlet hoses. Do not overtighten or use and mechanical devices to tighten the inlet hoses.

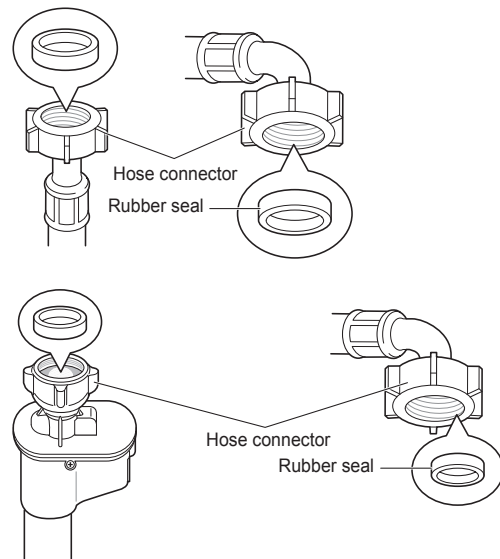

## Connecting Hose to Water Tap

### Connecting screw-type hose to tap with thread

Screw the hose connector onto the water supply tap.

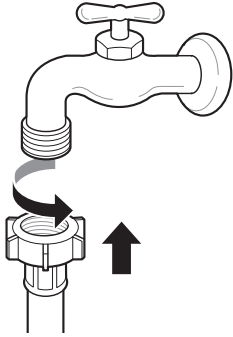

- 3 Push the inlet hose vertically upwards so that the rubber seal within the hose can adhere completely to the tap and then tighten it by screwing it to the right.

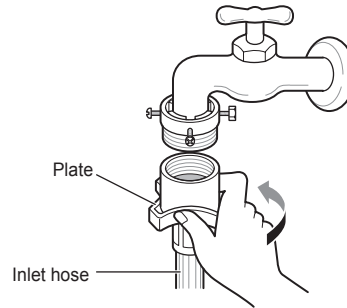

### Connecting screw-type hose to tap without thread

- 1 Loosen the four fixing screws.

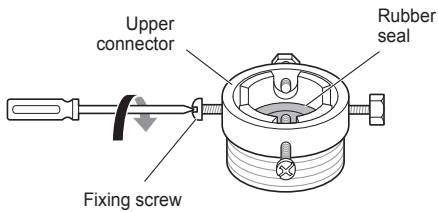

- 2 Push the adapter onto the end of the tap so that the rubber seal forms a watertight connection. Tighten the four fixing screws.

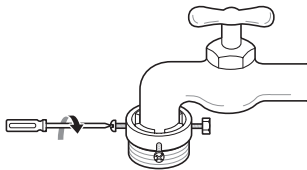

### Connecting one touch type hose to tap without thread

- 1 Unscrew the adapter ring plate and loosen the four fixing screws.

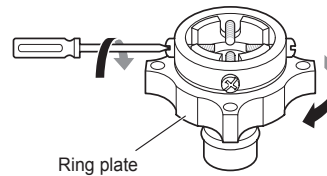

- 2 Remove the guide plate if the tap is too large to fit the adapter.

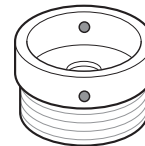
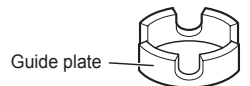

- 3** Push the adapter onto the end of the tap so that the rubber seal forms a watertight connection.

Tighten the adapter ring plate and the four fixing screws.

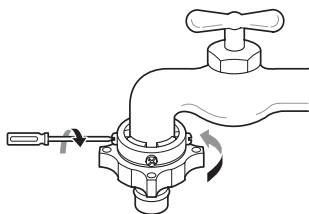

- 4** Pull the connector latch plate down, push the inlet hose onto the adapter, and release the connector latch plate. Make sure the adapter locks into place.

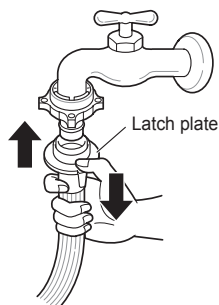

**NOTE**

- After connecting the inlet hose to the water tap, turn on the water tap to flush out foreign substances (dirt, sand, sawdust, etc.) in the water lines. Let the water drain into a bucket, and check the water temperature.

**Connecting Hose to Washing Machine**

Make sure that there are no kinks in the hose and that they are not crushed.

**When your washing machine has two valves.**

- The Inlet hose with the red connector is for the hot water tap.

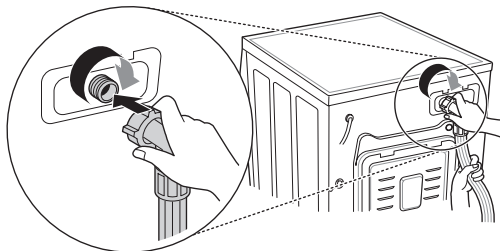

**NOTE**

- After completing connection, if water leaks from the hose, repeat the same steps. Use the most conventional type of tap for the water supply.

**Using the horizontal tap**

Horizontal tap



Extension tap

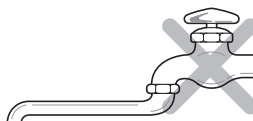

Square tap

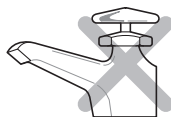

## Installation of Drain Hose

- The drain hose should not be placed higher than 100 cm above the floor. Water in the washing machine may not drain or may drain slowly.
- Securing the drain hose correctly will protect the floor from damage due to water leakage.
- If the drain hose is too long, do not force it back into the washing machine. This will cause abnormal noise.

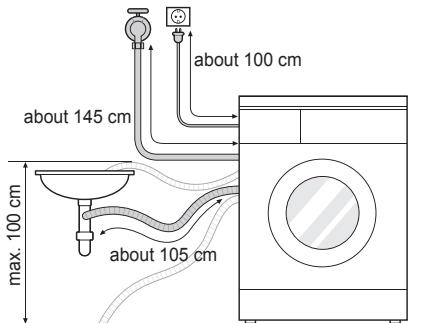

- When installing the drain hose to a sink, secure it tightly so that it cannot fall out due to the water forces when draining.
- Securing the drain hose correctly will protect the floor from damage due to water leakage.

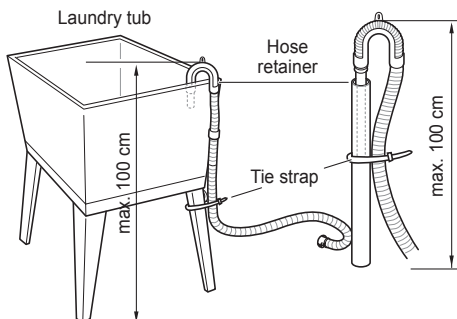
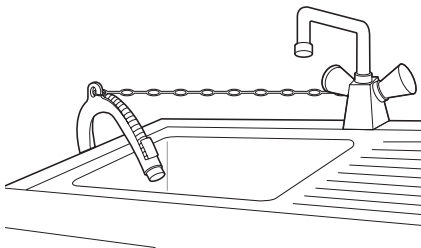

## Electrical Connections (In the UK Only)

The wires in the mains lead are coloured in accordance with the following code:

**Green and Yellow: Earth**

**Blue: Neutral**

**Brown: Live**

This appliance must be earthed.

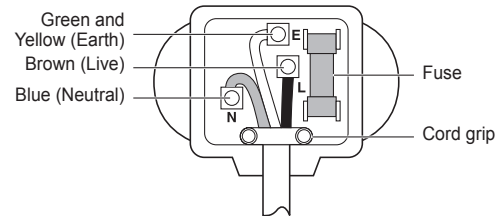

As the colours of the wires in the mains lead of this apparatus may not correspond with the coloured markings identifying the terminals in your plug, proceed as follows:

The green and yellow wire must be connected to the terminal in the plug which is marked with the letter E or by the earth symbol ( $\perp$ ) or coloured Green or Green and Yellow.

The blue wire must be connected to the terminal which is marked with the letter N or coloured Black.

The brown wire must be connected to the terminal which is marked with the letter L or coloured Red.

If a 13 amp (BS 1363) plug is used, fit a 13 amp BS 1362 fuse.

# OPERATION

## Using the Washing Machine

Before the first wash, select a cycle (Cotton 60°C, add a half load of detergent), allow the washing machine to wash without clothing. This will remove residue and water from the drum that may have been left during manufacturing. Use Front Loader Detergent only.

- 1 Sort laundry and load items.
  - Sort laundry by fabric type, soil level, colour and load size as needed. Open the door and load items into the washing machine.

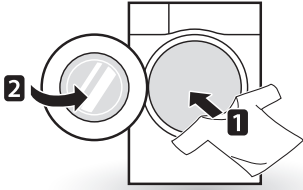

- 2 Add cleaning products and/or detergent and softener.
  - Add the proper amount of detergent to the detergent dispenser drawer. If desired, add bleach or fabric softener to the appropriate areas of the dispenser.

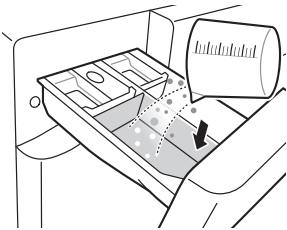

- 3 Turn on the washing machine.
  - Press the **Power** button to turn ON the washing machine.

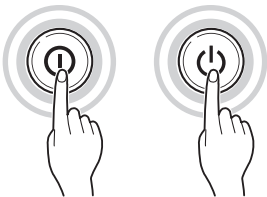

- 4 Choose the desired washing cycle.
  - Press the Cycle button repeatedly or turn the cycle selector knob until the desired cycle is selected.

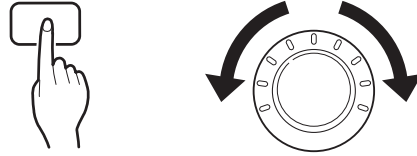

- 5 Begin cycle.
  - Press the **Start/Pause** button to begin the cycle. The washing machine will agitate briefly without water to measure the weight of the load. If the **Start/Pause** button is not pressed within 5 minutes, the washing machine will shut off and all settings will be lost.



- 6 End of cycle.
  - When the cycle is finished, a melody will sound. Immediately remove your clothing from the washing machine to reduce wrinkling. Check around the door seal when removing the load for small items that may be caught in the seal.



## Sorting laundry

### 1 Look for a care label on your clothes.

- This will tell you about the fabric content of your garment and how it should be washed.
- Symbols on the care labels.

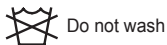
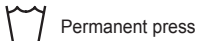
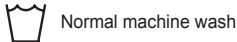

### 2 Sorting laundry.

- To get the best results, sort clothes into loads that can be washed with the same wash cycle.
- Different fabrics need to be washed at varying temperatures and spin speeds.
- Always sort dark colours from pale colours and whites. Wash separately as dye and lint transfer can occur causing discolouration of white and pale garments. If possible, do not wash heavily soiled items with lightly soiled ones.
  - Soil (Heavy, Normal, Light)  
Separate clothes according to amount of soil.
  - Colour (White, Lights, Darks)  
Separate white fabrics from coloured fabrics.
  - Lint (Lint producers, Collectors)  
Wash lint producers and lint collectors separately.

### 3 Caring before loading.

- Combine large and small items in a load. Load large items first.
- Large items should not be more than half the total wash load. Do not wash single items. This may cause an unbalanced load. Add one or two similar items.
- Check all pockets to make sure that they are empty. Items such as nails, hair clips, matches, pens, coins and keys can damage both your washing machine and your clothes.

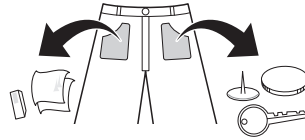

- Close zippers, hooks and strings to make sure that these items don't snag on other clothes.
- Pre-treat dirt and stains by brushing a small amount of detergent dissolved water onto stains to help lift dirt.
- Check the folds of the flexible gasket (gray) and remove any small articles.
- Check inside the drum and remove any items from a previous wash.

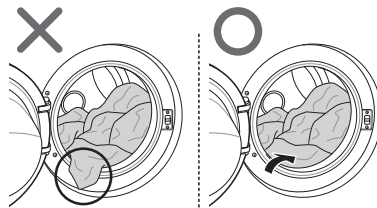

- Remove any clothing or items from the flexible gasket to prevent clothing and gasket damage.

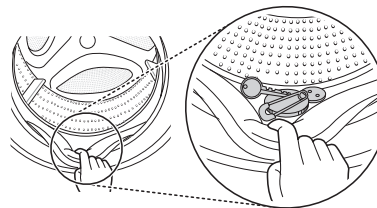

## Adding Cleaning Products

### Detergent Dosage



- Detergent should be used according to the instruction of the detergent manufacturer and selected according to type, colour, soiling of the fabric and washing temperature.
- If too much detergent is used, too many suds can occur and this will result in poor washing results or cause heavy loading on the motor and a potential malfunction.
- If you wish to use liquid detergent follow the guidelines provided by the detergent manufacturer.
- You can pour liquid detergent directly into the main detergent drawer if you are starting the cycle immediately.
- Do not use liquid detergent if you are using Time delay, or if you have selected Pre Wash, as the liquid may harden.
- If too many suds occur, reduce the detergent amount.
- Detergent usage may need to be adjusted for water temperature, water hardness, size and soil level of the load. For best results, avoid oversudsing.
- Refer to the label of the clothes, before choosing the detergent and water temperature:
- When using the washing machine, use designated detergent for each type of clothing only:
  - General powdered detergents for all types of fabric
  - Powdered detergents for delicate fabric
  - Liquid detergents for all types of fabric or designated detergents only for wool
- For better washing performance and whitening, use detergent with the general powdered bleach.
- Detergent is flushed from the dispenser at the beginning of the cycle.

### NOTE

- Do not let the detergent harden. Doing so may lead to blockages, poor rinse performance or odour.
- Full load : According to manufacturer's recommendation.
- Part load : 3/4 of the normal amount
- Minimum load : 1/2 of full load

## Adding Detergent and Fabric Softener

### Adding detergent

- Main wash only → 
- Pre wash+Main wash → 

### NOTE

- Too much detergent, bleach or softener may cause an overflow.
- Be sure to use the appropriate amount of detergent.

### Adding fabric softener

- Do not exceed the maximum fill line. Overfilling can cause early dispensing of the fabric softener, which may stain clothes. Close the dispenser drawer slowly.

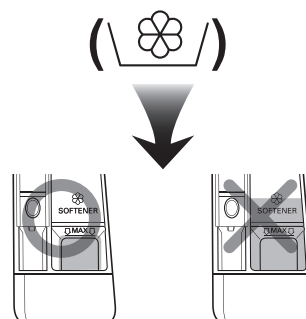

- Do not leave the fabric softener in the detergent drawer for more than 2 days (Fabric softener may harden).
- Softener will automatically be added during the last rinse cycle.
- Do not open the drawer when water is being supplied.
- Solvents (benzene, etc) must not be used.

**NOTE**

- Do not pour fabric softener directly on the clothes.

**Adding water softener**

- A water softener, such as Anti-limescale (e.g. Calgon) can be used to cut down on the use of detergent in extremely hard water areas. Dispense according to the amount specified on the packaging. First add detergent and then the water softener.
- Use the quantity of detergent required for soft water.

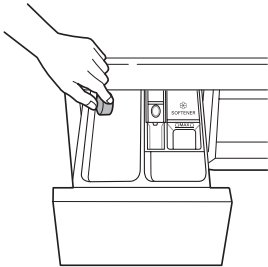
**Using tablet**

- 1 Open the door and put tablets into the drum.

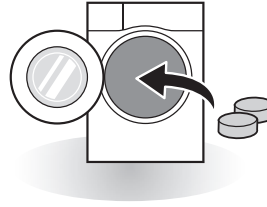

- 2 Load the laundry into the drum and close the door.

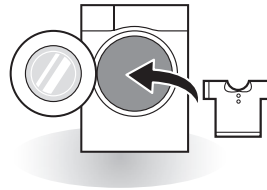

# Control Panel

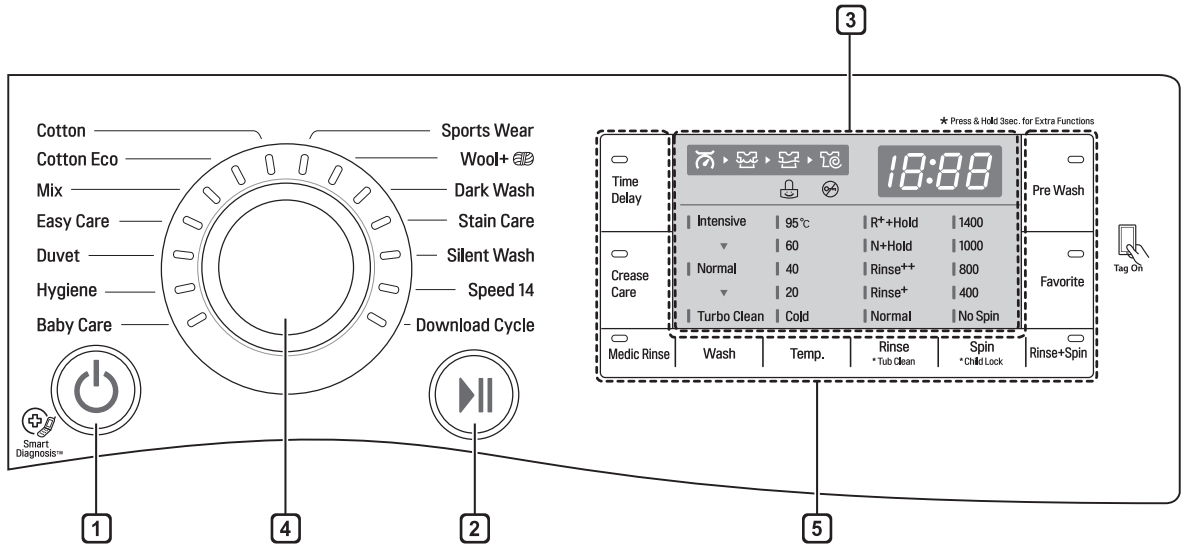

## 1 Power button

- Press the **Power** button to turn the washing machine on.
- To cancel the Time Delay function, the **Power** button should be pressed.

## 2 Start/Pause button

- This **Start/Pause** button is used to start the wash cycle or pause the wash cycle.
- If a temporary stop of the wash cycle is needed, press the **Start/Pause** button. If the wash is not resumed within 5min the machine will automatically turn off.

## 3 Display

- The display shows the settings, estimated time remaining, options, and status messages. When the product is turned on, the default settings in the display will illuminate.
- The display will show the estimated time remaining after it has calculated the load size. While the size of the load is being calculated automatically, blinking  or 'Detecting' appears.

## 4 Programme Dial

- Programmes should be appropriately selected to suit the laundry type.
- Lamp will light up to indicate the selected programme.

## 5 Options

- This allows you to select an additional option and will light when selected.
- Use these buttons to select the desired cycle options for the selected cycle. Not all Options may be available with all cycles (refer to pg.23)

## Programme Table

### Washing Programme

| Programme          | Description  | Fabric Type  | Proper Temp.           | Maximum Load   |
|--------------------|--|--|------------------------|----------------|
| <b>Cotton</b>      | Provides better performance by combining various drum motions.   | Coloured fast garments (shirts, nightdresses, pajamas, etc) and normally soiled cotton load (underwear).                                     | 40°C<br>(Cold to 95°C) | Rated capacity |
| <b>Cotton Eco</b>  | Provides optimised washing performance for a large amount of laundry with less energy consumption.   |  | 60°C<br>(Cold to 60°C) |                |
| <b>Easy Care</b>   | This cycle is suitable for casual shirts that do not need ironing after washing.   | polyamide, acrylic, polyester  | 40°C<br>(Cold to 60°C) | 4.0 kg         |
| <b>Mix</b>         | Enables various fabrics to be washed simultaneously.   | Various kind of fabrics except special garments (silk/delicate, sports wear, dark clothes, wool, duvet/curtains).                            | 40°C<br>(Cold to 40°C) |                |
| <b>Hygiene</b>     | Washes laundry in a hot cycle  | cotton, underwear, pillow covers, bed sheets, baby wear  | 60°C                   |                |
| <b>Silent Wash</b> | Provides less noise and vibration and saves money when used in lower energy tariff times.  | Color fast garments (shirts, nightdresses, pajamas, etc) and lightly soiled white cotton (underwear).  | 40°C<br>(Cold to 60°C) | 5.0 kg         |
| <b>Baby Care</b>   | Removes solid and protein stains, provides better rinse performance.   | Lightly soiled baby wear.  | 60°C<br>(60°C to 95°C) | 4.0 kg         |
| <b>Duvet</b>       | This cycle is for large items such as bed covers, pillows, sofa covers, etc.   | Cotton bedding except special garments (delicates, wool, silk, etc.) with filling: duvets, pillows, blankets, sofa covers with light filling | 40°C<br>(Cold to 40°C) | 1 single size  |
| <b>Sports Wear</b> | This cycle is suitable for sports wear such as jogging clothes and sports wear.  | coolmax, gore-tex, fleece and sympatex   |                        | 3.0 kg         |
| <b>Dark Wash</b>   | If it's possible for clothes to discolour, please use this cycle. This cycle helps prevent discolouring. (Please use detergent for colored fabrics.) | Dark garments made from cotton or mixed fabrics.   | 20°C<br>(Cold to 40°C) |                |

| Programme             | Description  | Fabric Type  | Proper Temp.           | Maximum Load |
|-----------------------|--|--|------------------------|--------------|
| <b>Speed 14</b>       | This cycle provides fast washing time for small loads and lightly soiled clothes.  | Coloured laundry which is lightly soiled fast.<br>CAUTION : Use less than 20g of detergent (for 2.0kg load) otherwise detergent may remain on the clothes. | 20°C<br>(20°C to 40°C) | 2.0 kg       |
| <b>Wool+</b>          | This cycle is for hand and machine washable delicate clothes such as washable wool, lingerie, dresses etc. (Use detergent for machine washable woolens). | wool, hand washable clothes, delicate, easily damaged laundry  | 20°C<br>(Cold to 20°C) | 1.5 kg       |
| <b>Stain Care</b>     | Wash off several kinds of stain such as wine, juice, dirt, etc. (Water temperature is increased step by step for washing various stains.)                | cotton blended fabrics, NO delicate clothes  | 40°C<br>(40°C to 60°C) | 3.0 kg       |
| <b>Download Cycle</b> | For downloadable cycles. If you did not download any cycles, the default is Rinse+Spin.  |  |                        |              |

- Water Temperature: Select the appropriate water temperature for chosen wash cycle. Always follow garment manufacturer's care label or instructions when washing.
- Set program at "Cotton Eco, 40°C, Normal Wash & Rinse, 1400RPM" is for normally soiled load and test in accordance or in conformity with AS/NZS 2040.1.
- The test results depend on water pressure, water hardness, water inlet temperature, room temperature, type and amount of load, degree of soiling utilized detergent, fluctuations in the main electricity supply and chosen additional options.

**NOTE**

- Neutral detergent is recommended.

## Extra Options

| Programme   | Turbo Clean | Pre Wash | Rinse+ | Intensive | Rinse Hold | Medic Rinse | Crease Care | Favorite | Time Delay |
|-------------|-------------|----------|--------|-----------|------------|-------------|-------------|----------|------------|
| Cotton      | ●           | ●        | ●      | ●         | ●          | ●           | ●           | ●        | ●          |
| Cotton Eco  | ●           | ●        | ●      |           | ●          | ●           | ●           | ●        | ●          |
| Easy Care   | ●           | ●        | ●      | ●         | ●          | ●           | ●           | ●        | ●          |
| Mix         | ●           | ●        | ●      | ●         | ●          | ●           | ●           | ●        | ●          |
| Hygiene     |             |          | ●      | ●         | ●          | ●           | ●           | ●        | ●          |
| Silent Wash |             |          | ●      | ●         | ●          |             | ●           | ●        | ●          |
| Baby Care   |             | ●**      | ●      | ●         | ●          | ●**         | ●           | ●        | ●          |
| Duvet       |             |          | ●      | ●         | ●          |             | ●           | ●        | ●          |
| Sports Wear |             |          | ●      | ●         | ●          |             | ●           | ●        | ●          |
| Dark Wash   |             |          | ●      | ●         | ●          |             | ●           | ●        | ●          |
| Speed 14    | ●*          |          | ●      |           |            |             | ●           | ●        | ●          |
| Wool+       |             |          | ●      |           |            |             | ●           | ●        | ●          |
| Stain Care  |             | ●*       | ●      |           | ●          | ●           | ●           | ●        | ●          |

\* : This option is automatically included in the cycle and can not be deleted.

\*\* : This option is automatically included in the cycle and can be deleted.

## Operating Data

| <b>Programme</b> | <b>Max RPM</b> |
|------------------|----------------|
| Cotton           | 1400           |
| Cotton Eco       | 1400           |
| Easy Care        | 1000           |
| Mix              | 1400           |
| Hygiene          | 1400           |
| Silent Wash      | 1000           |
| Baby Care        | 1000           |
| Duvet            | 1000           |
| Sports Wear      | 800            |
| Dark Wash        | 1400           |
| Speed 14         | 800            |
| Wool+            | 800            |
| Stain Care       | 1400           |



## Option Cycle

### Time Delay

You can set a time delay so that the washing machine will start automatically and finish after a specified time interval.

- 1 Press the **Power** button.
- 2 Select a washing programme.
- 3 Press the **Time Delay** button and set time required.
- 4 Press the **Start/Pause** button.

#### NOTE

- The delay time is the time to the end of the programme, not the start. The actual running time may vary due to water temperature, wash load and other factors. Do not use Liquid detergent for this operation.

### Crease Care

To reduce creasing, select the Crease Care option.

- 1 Press the **Power** button.
- 2 Select a cycle.
- 3 Press the **Crease Care** button.
- 4 Press the **Start/Pause** button.

### Pre Wash

If the laundry is heavily soiled, the Pre Wash cycle is recommended.

- 1 Press the **Power** button.
- 2 Select a washing programme.
- 3 Press the **Pre Wash** button.
- 4 Press the **Start/Pause** button.

### Favorite

Favorite programme allows you to store a customized wash cycle for future use.

- 1 Press the **Power** button.
- 2 Select a washing programme.
- 3 Select the cycle (Washing method, number of rinses, spin speed, water temperature etc.).
- 4 Press and hold the **Favorite** button for 3 seconds.

The favorite programme is now stored for future use.

To reuse the programme, select favorite programme and press the **Start/Pause** button.

### Medic Rinse

For best results or for cleaner rinsing.

This allows the final rinse to be heated to 40 degrees.

- 1 Press the **Power** button.
- 2 Select a cycle.
- 3 Press the **Medic Rinse** button and set time required.
- 4 Press the **Start/Pause** button.

## Wash

### Turbo Clean

Wash cycle in under 1 hour with energy and water saving. (based on half loads)

### Intensive

If the load is normal and heavily soiled, the **Intensive** option is effective.

### Temp.

The **Temp.** button selects the wash temperature for the selected cycle. Press this button until the desired setting is lit. All rinses use the water from the cold water hose connection.

- Select the water temperature suitable for the type of load you are washing. Follow the garment fabric care labels for best results.

### Rinse

#### Rinse+

Adds an additional rinse.

#### Rinse++

Adds 2 additional rinses.

#### R<sup>+</sup>+Hold

Adds 1 additional rinse, then after rinsing process, the course is paused until start button is pressed again.

#### N+Hold

The cycle is paused until start button is pressed again when rinse is finished.

## Spin

- Spin speed level can be selected by pressing the **Spin** button repeatedly.

- Spin Only

- 1** Press the **Power** button.
- 2** Press the **Spin** button to select RPM.
- 3** Press the **Start/Pause** button.

### NOTE

- When you select 'No Spin', it will still rotate for a short time to drain quickly.

## Rinse+Spin

This can be helpful in preventing fresh stains from setting in fabrics. This is a separate cycle.

- 1** Press the **Power** button.
- 2** Select a cycle.
- 3** Press the **Rinse+Spin** button.
- 4** Press the **Start/Pause**.

## Child Lock ( )

Select this function to lock the buttons on the control assembly to prevent tampering.

### Locking the control panel

**1** Press and hold the **Child Lock (Spin)** button for 3 seconds.

**2** A beep will sound, and 'L L' will appear on the display.

When the child lock is set, all buttons are locked except the **Power** button.

#### NOTE

- Turning off the power will not reset the child lock function. You must deactivate child lock before you can access any other functions.

### Unlocking the control panel

Press and hold the **Child Lock (Spin)** button for 3 seconds.

- A beep will sound and the remaining time for the current programme will reappear on the display.

## Beep On / Off

**1** Press the **Power** button.

**2** Press the **Start/Pause** button.

**3** Press and hold the **Crease Care** and **Pre Wash** button simultaneously for 3 seconds to set the Beep on/off function.

#### NOTE

- Once the Beep on/off function is set, the setting is memorized even after the power is turned off.
- If you want to turn the Beeper off, simply repeat this process.

## Using Smart Function (Optional)

### Using the Tag On Function

The Tag On function allows you to conveniently use the LG Smart Diagnosis™ and Cycle Download features to communicate with your appliance right from your own smart phone.

- The Tag On function can only be used with most smart phones equipped with the NFC function and based on the Android operating system (OS).

### Installation of the application

- Search "LG Smart Laundry" on the Google Play Store from your smart phone.

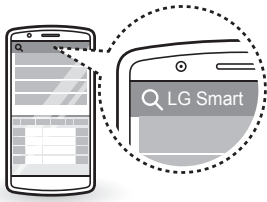

## Using the Application

LG Smart Laundry application allows you to use various features for your convenience.

- Cycle Download
- Smart Diagnosis™
- Tag On Cycle Set
- Laundry Stats

### NOTE

- Press **?** in the LG Smart Laundry application for a more detailed guide on how to use the Tag On function.
- Depending on the smart phone manufacturer and Android OS version, the NFC activation process may differ. Refer to the manual of your smart phone for details.
- Because of the characteristics of NFC, if the transmission distance is too far, or if there is a metal sticker or a protective case on the phone, transmission will not be good. In some cases, NFC-equipped phones may be unable to transmit successfully.
- The content found in this manual may differ depending on the version of "LG Smart Laundry" application, and it may be modified without informing customers.

## **⚠ WARNING**

- Unplug the washing machine before cleaning to avoid the risk of electric shock. Failure to follow this warning may result in serious injury, fire, electric shock, or death.
- Never use harsh chemicals, abrasive cleaners, or solvents to clean the washing machine. They may damage the finish.

## Cleaning your Washing Machine

### Care After Wash

- After the cycle is finished, wipe the door and the inside of the door seal to remove any moisture.
- Leave the door open to dry the drum interior.
- Wipe the body of the washing machine with a dry cloth to remove any moisture.

### Cleaning the Exterior

Proper care of your washing machine can extend its life.

#### Door:

- Wash with a damp cloth on the outside and inside and then dry with a soft cloth.

#### Exterior:

- Immediately wipe off any spills.
- Wipe with a damp cloth.
- Do not press the surface or the display with sharp objects.

## Care and Cleaning of the Interior

- Use a towel or soft cloth to wipe around the washing machine door opening and door glass.
- Always remove items from the washing machine as soon as the cycle is complete. Leaving damp items in the washing machine can cause wrinkling, colour transfer, and odour.
- Run the Tub Clean cycle once a month (or more often if needed) to remove detergent buildup (Scrud) and other residue.

## Cleaning the Water Inlet Filter

- Turn off the supply taps to the machine if the washing machine is to be left for any length of time (e.g. holiday), especially if there is no floor drain (gully) in the immediate vicinity.
- 'E' icon will be displayed on the control panel when water is not entering the detergent drawer.
- If water is very hard or contains traces of lime deposit, the water inlet filter may become clogged. It is therefore a good idea to clean it occasionally.

- 1 Turn off the water tap and unscrew the water inlet hose.

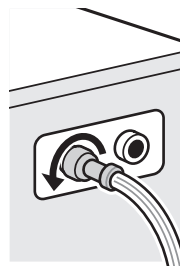

- 2 Clean the filter using a hard bristle brush.

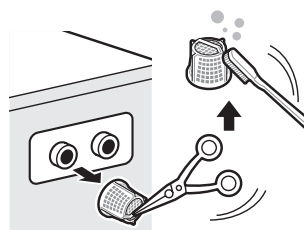

## Cleaning the Drain Pump Filter

- The drain filter collects threads and small objects left in the laundry. Check regularly that the filter is clean to ensure smooth running of your washing machine.
- Allow the water to cool down before cleaning the drain pump, carrying out emergency emptying, or opening the door in an emergency.

1 Open the cover cap and pull out the hose.

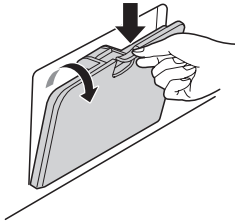

2 Unplug the drain plug to drain out all the residual water into a vessel, and then open the filter by turning it to the left.

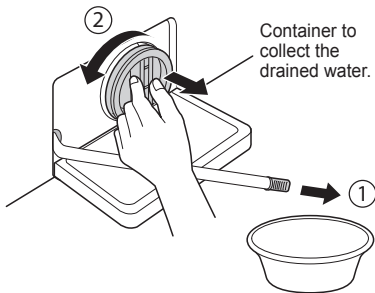

3 Remove any extraneous matter from the pump filter.

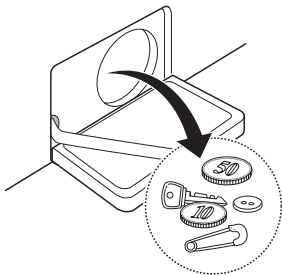

4 After cleaning, refit the drain cap by turning it clockwise and then insert the drain plug.

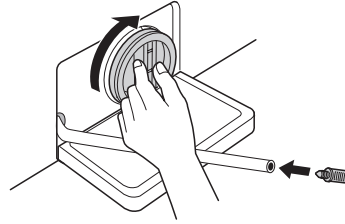

5 Close the cover cap.

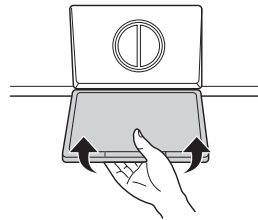

### CAUTION

- First drain using the drain hose and then open the pump filter to remove any threads or objects.
- Be careful when draining, as the water may be hot.

## Cleaning the Dispenser Drawer

Detergent and fabric softener may build up in the dispenser drawer. Remove the drawer and inserts and check for buildup once or twice a month.

- 1 Remove the detergent dispenser drawer by pulling it straight out until it stops.
  - Press down hard on the disengage button and remove the drawer.

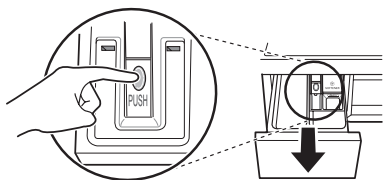

- 2 Remove the inserts from the drawer.
  - Rinse the inserts and the drawer with warm water to remove buildup from laundry products. Use only water to clean the dispenser drawer. Dry the inserts and drawer with a soft cloth or towel.
- 3 To clean the drawer opening, use a cloth or an old toothbrush brush to clean the recess.
  - Remove all residue from the upper and lower parts of the recess.
- 4 Wipe any moisture off the recess with a soft cloth or towel.
- 5 Return the inserts to the proper compartments and refit the drawer.

## Tub Clean (Optional)

Tub Clean is a special cycle to clean the inside of the washing machine.

A higher water level is used in this cycle at higher spin speed. Perform this cycle regularly.

- 1 Remove any clothing or items from the washing machine and close the door.
- 2 Open the dispenser drawer and add Anti limescale (e.g. Calgon) to the main wash compartment.
- 3 Close the dispenser drawer slowly.
- 4 Power On and then press and hold **Tub Clean** button for 3 seconds. Then 't c t' will be displayed on the display.
- 5 Press the **Start/Pause** button to start.
- 6 After the cycle is complete, leave the door open to allow the washing machine door opening, flexible gasket and door glass to dry.

### CAUTION

- If there is a child, be careful not to leave the door open for too long.

### NOTE

- Do not add any detergent to the detergent compartments. Excessive suds may generate and leak from the washing machine.

## Caution on Freezing During Winter

- When frozen, the product does not operate normally. Make sure to install the product where it will not freeze during winter.
- In case the product must be installed outside on a porch or in other outdoor conditions, make sure to check the following.

- After closing the tap, disconnect the cold inlet hose from the tap, and remove water while keeping the hose facing downwards.

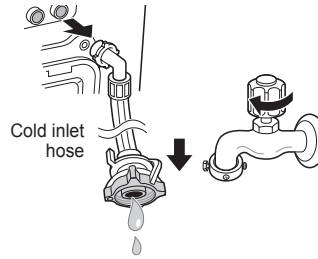

## How to Keep the Product from Freezing

- After washing, remove water remaining inside the pump completely with the opening hose plug used for removal of residual water. When the water is removed completely, close the hose plug used for removal of residual water and cover cap.

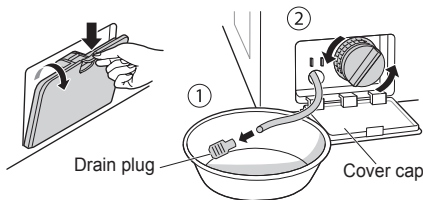

- Hang down drain hose to pull out water inside the hose completely.

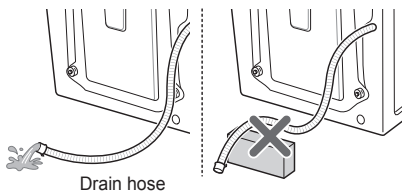

### CAUTION

- When the drain hose is installed in a curved shape, the inner hose may freeze.

## Check for Freezing

- If water does not drain when opening the hose plug used for removal of residual water, check the drainage unit.



- Turn the power on, select Rinse and Spin, and press the **Start/Pause** button.

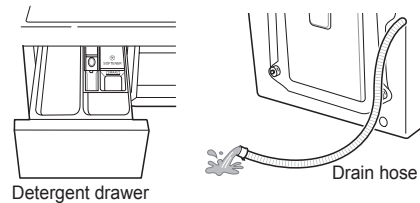

### NOTE

- Check that water is coming into the detergent drawer while rinsing, and water is draining through the drain hose while spinning.
- When 'FF' is shown in display window while the product is in operation, check water supply unit and drainage unit (Some models do not have an alarm function that indicates freezing).



## How to Handle Freezing

- Make sure to empty the drum, pour warm water of 50–60°C up to the rubber part inside the drum, close the door, and wait for 1–2 hours.

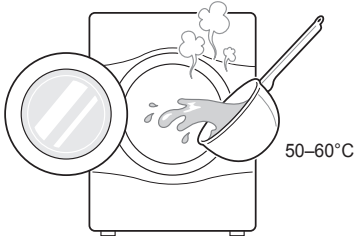

### CAUTION

- Do not use boiling water. It may cause burns or damage to the product.
- Open the cover cap and hose plug used for removal of residual water to extract water completely.

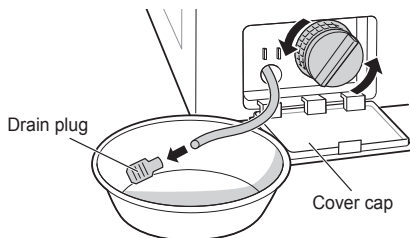

### NOTE

- If when water does not drain, this means the ice is not melted completely. Wait more.

- When water is removed completely from the drum, close the hose plug used for removal of residual water, select Rinse and Spin, and press the **Start/Pause** button.

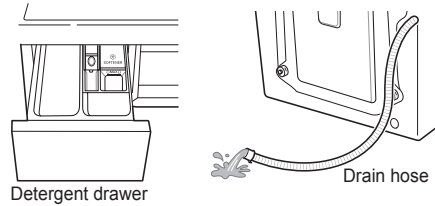

### NOTE

- Check that water is coming into the detergent drawer while rinsing, and water is draining through the drain hose while spinning.
- When water supply problems occur, take the following measures.
  - Turn off the tap, and thaw out the tap and both connection areas of inlet hose of the product using a hot water cloth.
  - Take out inlet hose and immerse in warm water below 50–60°C.

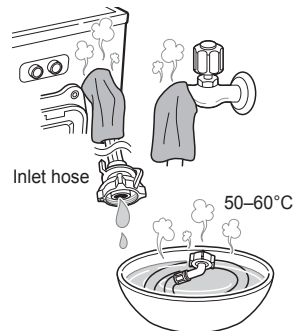

## Using the Smart Diagnosis™ Function

Use this function if you need an accurate diagnosis by an LG Electronics service centre when the product malfunctions or fails. Use this function only to contact the service representative, not during normal operation.

- 1 Press the **Power** button to turn on the washing machine. Do not press any other buttons or turn the cycle selector knob.
- 2 When instructed to do so by the call centre, place the mouthpiece of your phone close to the **Power** button.

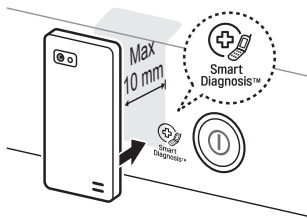

- 3 Press and hold the **Temp.** button for 3 seconds, while holding the phone mouthpiece to the icon or **Power** button.
- 4 Keep the phone in place until the tone transmission has finished. Time remaining for data transfer is displayed.
  - For best results, do not move the phone while the tones are being transmitted.
  - If the call centre agent is not able to get an accurate recording of the data, you may be asked to try again.



- 5 Once the countdown is over and the tones have stopped, resume your conversation with the call centre agent, who will then be able to assist you using the information transmitted for analysis.

### NOTE

- The Smart Diagnosis™ function depends on the local call quality.
- The communication performance will improve and you can receive better service if you use the home phone.
- If the Smart Diagnosis™ data transfer is poor due to poor call quality, you may not receive accurate Smart Diagnosis™ results.

# TROUBLESHOOTING







- Your washing machine is equipped with an automatic error-monitoring system to detect and diagnose problems at an early stage. If your washing machine does not function properly or does not function at all, check the following before you call for service:















## Diagnosing Problems

| Symptoms  | Reason  | Solution  |
|---|---|---|
| <b>Rattling and clanking noise</b>                                  | <b>Foreign objects such as coins or safety pins may be in drum or pump.</b>   | <ul style="list-style-type: none"> <li>• Stop washing machine, check drum and drain filter.</li> <li>• If noise continues after washing machine is restarted, call your authorised service centre.</li> </ul> |
| <b>Thumping sound</b>   | <b>Heavy wash loads may produce a thumping sound. This is usually normal.</b> | <ul style="list-style-type: none"> <li>• If sound continues, washing machine is probably out of balance. Stop and redistribute wash load.</li> </ul>  |
| <b>Vibrating noise</b>  | <b>Have all the transit bolts and tub support been removed?</b>               | <ul style="list-style-type: none"> <li>• If not removed during installation, refer to Installation guide for removing transit bolts.</li> </ul>   |
|   | <b>Are all the feet resting firmly on the ground?</b>                         | <ul style="list-style-type: none"> <li>• Wash load may be unevenly distributed in drum. Stop washing machine and rearrange wash load.</li> </ul>  |
| <b>Water leaks</b>  | <b>Inlet hoses or drain hose are loose at tap or washing machine.</b>         | <ul style="list-style-type: none"> <li>• Check and tighten hose connections.</li> </ul>   |
|   | <b>House drain pipes are clogged.</b>   | <ul style="list-style-type: none"> <li>• Unclog drain pipe. Contact plumber if necessary.</li> </ul>  |
| <b>Oversudsing</b>  |   | <ul style="list-style-type: none"> <li>• Too much detergent or unsuitable detergent may cause excessive foaming which may result in water leaks.</li> </ul>   |
| <b>Water does not enter washing machine or it enters slowly</b>     | <b>Water supply is not adequate in that location.</b>                         | <ul style="list-style-type: none"> <li>• Check another tap in the house.</li> </ul>   |
|   | <b>Water supply tap is not completely open.</b>                               | <ul style="list-style-type: none"> <li>• Fully open tap.</li> </ul>   |
|   | <b>Water inlet hose(s) are kinked.</b>  | <ul style="list-style-type: none"> <li>• Straighten hose.</li> </ul>  |
|   | <b>The filter of the inlet hose(s) clogged.</b>                               | <ul style="list-style-type: none"> <li>• Check the filter of the inlet hose.</li> </ul>   |
| <b>Water in the washing machine does not drain or drains slowly</b> | <b>Drain hose is kinked or clogged.</b>                                       | <ul style="list-style-type: none"> <li>• Clean and straighten the drain hose.</li> </ul>  |
|   | <b>The drain filter is clogged.</b>   | <ul style="list-style-type: none"> <li>• Clean the drain filter.</li> </ul>   |

| Symptoms                       | Reason   | Solution  |
|--------------------------------|--|---|
| Washing machine does not start | Electrical power cord may not be plugged in or connection may be loose.    | <ul style="list-style-type: none"> <li>• Make sure plug fits tightly in wall outlet.</li> </ul>   |
|                                | House fuse blown, circuit breaker tripped, or a power outage has occurred. | <ul style="list-style-type: none"> <li>• Reset circuit breaker or replace fuse. Do not increase fuse capacity. If problem is a circuit overload, have it corrected by a qualified electrician.</li> </ul>   |
|                                | Water supply tap is not turned on.   | <ul style="list-style-type: none"> <li>• Turn on water supply tap.</li> </ul>   |
| Washing machine will not spin  | Check that the door is firmly shut.  | <ul style="list-style-type: none"> <li>• Close the door and press the <b>Start/Pause</b> button. After pressing the <b>Start/Pause</b> button, it may take a few moments before the washing machine begins to spin. The door must be locked before spin can be achieved. Add 1 or 2 similar items to help balance the load. Rearrange load to allow proper spinning.</li> </ul> |
| Door does not open             |  | <ul style="list-style-type: none"> <li>• Once washing machine has started, the door cannot be opened for safety reasons. Check if the 'Door Lock' icon is illuminated. You can safely open the door after the 'Door Lock' icon turns off.</li> </ul>  |
| Wash cycle time delayed        |  | <ul style="list-style-type: none"> <li>• The washing time may vary by the amount of laundry, water pressure, water temperature and other usage conditions. If an imbalance is detected or if the suds removing programme is on, the wash time will increase.</li> </ul>   |
| Fabric softener overflow       | Too much softener may cause an overflow.                                   | <ul style="list-style-type: none"> <li>• Follow softener guidelines to ensure appropriate amount is used. Do not exceed the maximum fill line.</li> </ul>   |
| Softeners dispensed too early  |  | <ul style="list-style-type: none"> <li>• Close the dispenser drawer slowly. Do not open the drawer during the wash cycle.</li> </ul>  |
| Dry problem                    | Does not dry   | <ul style="list-style-type: none"> <li>• Do not overload. Check that the washing machine is draining properly to extract adequate water from the load. Clothes load is too small to tumble properly. Add a few towels.</li> </ul>   |

## Error Messages

| Symptoms  | Reason   | Solution   |
|---|--|--|
|    |  <p><b>Water supply is not adequate in area.</b></p> <p><b>Water supply taps are not completely open.</b></p> <p><b>Water inlet hose(s) are kinked.</b></p> <p><b>The filter of the inlet hose(s) are clogged.</b></p> <p><b>If water leakage occurred in the inlet hose, indicator <b>A</b> will become red.</b></p>  <p>• May vary depending on the model.</p>                 | <ul style="list-style-type: none"> <li>• Check another tap in the house.</li> <li>• Fully open tap.</li> <li>• Straighten hose(s).</li> <li>• Check the filter of the inlet hose.</li> </ul>   |
|  |  <p><b>Drain hose is kinked or clogged.</b></p> <p><b>The drain filter is clogged.</b></p>  | <ul style="list-style-type: none"> <li>• Clean and straighten the drain hose.</li> <li>• Clean the drain filter.</li> </ul>  |
|  |  <p><b>Load is too small.</b></p> <p><b>Load is out of balance.</b></p> <p><b>The appliance has an imbalance detection and correction system. If individual heavy articles are loaded (e.g. bath mat, bath robe, etc.) this system may stop spinning or even interrupt the spin cycle altogether.</b></p> <p><b>If the laundry is still too wet at the end of the cycle, add smaller articles of laundry to balance the load and repeat the spin cycle.</b></p> | <ul style="list-style-type: none"> <li>• Add 1 or 2 similar items to help balance the load.</li> <li>• Add 1 or 2 similar items to help balance the load.</li> <li>• Rearrange load to allow proper spinning.</li> <li>• Rearrange load to allow proper spinning.</li> </ul> |

| Symptoms   |   | Reason   | Solution  |
|--|---|--|---|
|   | <br><br> | Ensure door is not open.                       | <ul style="list-style-type: none"> <li>• Close the door completely.</li> <li>• If 'dE, dE 1, dE2' is not released, call for service.</li> </ul>           |
|   |    |  | <ul style="list-style-type: none"> <li>• Unplug the power plug and call for service.</li> </ul>   |
|   |    | Water overfills due to the faulty water valve. | <ul style="list-style-type: none"> <li>• Close the water tap.</li> <li>• Unplug the power plug.</li> <li>• Call for service.</li> </ul>                   |
|   |    | Water level sensor has malfunctioned.          | <ul style="list-style-type: none"> <li>• Close the water tap.</li> <li>• Unplug the power plug.</li> <li>• Call for service.</li> </ul>                   |
|   |    | Over load in motor.                            | <ul style="list-style-type: none"> <li>• Allow the washing machine to stand for 30 minutes to allow the motor to cool, then restart the cycle.</li> </ul> |
|  |   | Water leaks.                                   | <ul style="list-style-type: none"> <li>• Call for service.</li> </ul>   |
|  |    | Control Error                                  | <ul style="list-style-type: none"> <li>• Unplug power plug and call for service.</li> </ul>   |

# Memo

