



5717010131 / 02.14



Consumer Helpline

Australia

Phone: 1800 126 659

Fax: 1800 007 289

New Zealand

Phone: 0508 200 300

Fax: 0508 200 301

www.delonghi.com.au

www.delonghi.co.nz

Distributed by De'Longhi Australia Pty Ltd.
ABN 49 104 012 857
P.O. Box 4540 Casula Mall, NSW 2170

Distributed by De'Longhi New Zealand Ltd.
P.O. Box 58-056 Botany, MANUKAU 2163

 is a registered Trademark
of De'Longhi Australia Pty Ltd.
ABN 49 104 012 857.

© 2013 De'Longhi Australia Pty Ltd.

De'Longhi Inbuilt Wine Cabinet

Model
DEIBWC22B



USER GUIDE

Please read this user guide carefully and retain for future reference

- Parts and Features 03
- De'Longhi Safety Precautions 04
- Inbuilt Wine Cabinet Safety Precautions 05
- Installation Safety Precautions 08
- Installation 09
 - Warnings
 - Before using your Inbuilt Wine Cabinet
 - Installation of your Inbuilt Wine Cabinet
 - Clearances
 - How to remove the shelf
 - Reversing the door swing of your appliance
- Using your Inbuilt Wine Cabinet 13
 - ON/OFF power
 - Setting the temperature control
 - Interior light
- Care and Cleaning 14
 - LED light isn't working
 - Cleaning your Inbuilt Wine Cabinet
 - Power failure
 - Vacation Time
 - Moving your Inbuilt Wine Cabinet
 - Energy saving tips
- Troubleshooting 15
- Help us Help You 16
- Warranty Information 17

Model: DEIBWC22B

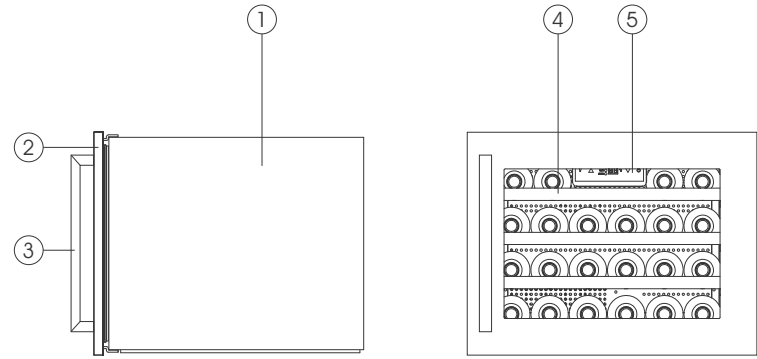

- Components:**
- 1. Wine cabinet housing
 - 2. UV tinted triple glaze door
 - 3. Handle
 - 4. Shelf
 - 5. Digital control panel

Dimensions (Door):
 Height 455mm
 Width 595mm

Dimensions (Cabinet Housing):
 Height 445mm
 Width 555mm
 Depth 520mm

De'Longhi pride themselves on their innovative range of the highest quality consumer products.

De'Longhi ensures all of its products are 100% safe through quality design and manufacture. All products meet or exceed stringent laboratory-tested safety requirements.

It is necessary for anyone using an electrical appliance to be safety conscious. The following precautions are essential for the safe use of an electrical appliance. Carefully read all of the instructions provided with your appliance:

- Always turn the power off at the power outlet before you insert or remove a plug. Remove by grasping the plug, do not pull on the cord.
- Do not use your appliance with an extension cord unless this cord has been checked and tested by a qualified technician or service person. The extension cord must be a VDE-Listed, 3-wire grounding extension cord that has a grounding plug and outlet and that the electrical rating of the cord is 220-240 volts and at least 10 amperes.
- Always use your appliance from a power outlet of the voltage (A.C. only) marked on the appliance.
- Do not use an appliance for any purpose other than its intended use.
- Do not attempt to repair an electrical appliance. Return a damaged or malfunctioning appliance to a qualified service centre for adjustment or repair if required.
- The appliance must be positioned so the AC plug is accessible.

- This appliance is designed exclusively for household use. All other uses are strictly forbidden.
- The appliance is not intended for use by persons (including children) with reduced physical, sensory or mental capabilities, or lack of experience and knowledge, unless they have been given supervision or instruction concerning use of the appliance by a person responsible for their safety. Children should be supervised to ensure that they do not play with the appliance.
- If the power cable is damaged, it must be replaced by the manufacturer, an authorised service centre or a qualified electrician in order to eliminate all risk.
- **WARNING:** Do not damage the refrigerant circuit.

The De'Longhi Inbuilt Wine Cabinet is warranted against faults resulting from manufacturing or material defects. The warranty period for normal domestic installation and use is three years from the date of purchase. In non-domestic use De'Longhi limits the voluntary warranty to 6 months.

De'Longhi undertakes to repair or replace the Inbuilt Wine Cabinet at our discretion if the product is found to be defective due to a manufacturing fault during the warranty period.

This warranty excludes any damage caused by misuse, neglect, shipping accident, or incorrect installation. Normal wear and tear is also expressly excluded. The warranty claim is void if no fault is found with the product or if work is carried out by anyone other than an authorised De'Longhi Service Agent.

In Australia, this warranty is additional to the conditions and guarantees which are mandatory as implied under the Trade Practices Act 1974 and State and Territory legislation.

How to contact us about a warranty claim

Talk to a De'Longhi representative for further warranty or product information please call the number in your country:

Australia

www.delonghi.com.au
Phone: 1800 126 659

New Zealand

www.delonghi.co.nz
Phone: 0508 200 300

NOTE: Warranty is determined by unit serial number and date of purchase.

Read this guide carefully, it is intended to help you operate and maintain your new Inbuilt Wine Cabinet properly.

Keep it handy to answer your questions. If you don't understand something or you need more assistance, please call the De'Longhi Helpline.

To help us provide prompt answers to your queries, please record your Inbuilt Wine Cabinet model and serial numbers. You'll find them on a plate located on the rear outside wall of the Inbuilt Wine Cabinet.

Inbuilt Wine Cabinet details

Date of Purchase

Model Number

Serial Number

Before you call for service

Check the Troubleshooting Section on page 15. It lists causes of minor operating problems that you can correct yourself.

STAPLE OR
AFFIX PURCHASE
RECIPT HERE

IMPORTANT SAFETY INSTRUCTIONS - READ ALL INSTRUCTIONS BEFORE USING, AND SAVE FOR FUTURE REFERENCE.

Your safety and the safety of others is very important. Safety messages are displayed in this manual and on your appliance.

Read and obey these safety messages as they will alert you to potential hazards and tell you how to reduce the chance of injury.



Safety Alert Symbol

This symbol alerts you to potential hazards.

 **DANGER** 

Danger

Danger indicates a high level of risk to yourself and others. Ensure that care is taken to avoid severe injury or even death.

 **WARNING** 

Warning

Warning indicates a moderate level of risk to yourself, others and the product. Ensure that care is taken to avoid extensive product damage or serious injury.

CAUTION

Caution

Caution indicates a level of risk to yourself, others and the product. Ensure care is taken to avoid moderate product damage or injuries.



Before the appliance is used, it must be properly positioned and installed as described in this manual, so read the manual carefully. To reduce the risk of fire, electrical shock or injury when using the appliance, follow basic precaution, including the following:



Caution:
risk of fire

⚠ DANGER ⚠

- Plug into a grounded 3-prong outlet, do not remove grounding prong, do not use an adapter, and do not use an extension cord.
- It is recommended that a separate circuit, serving only your appliance be provided. Use receptacles that cannot be turned off by a switch or pull chain.
- Never clean appliance parts with flammable fluids. These fumes can create a fire hazard or explosion. And do not store or use gasoline or other flammable vapours and liquids in the vicinity of this or any other appliance. The fumes can create a fire hazard or explosion.
- Do not connect or disconnect the electric plug when your hands are wet.
- Unplug the appliance or disconnect power before cleaning or servicing. Failure to do so can result in electrical shock or death.
- Do not attempt to repair or replace any part of your appliance unless it is specifically recommended in this material. All other servicing should be referred to a qualified technician.

R600a Refrigerant Warning

- This appliance contains a small quantity of R600a refrigerant which is environmentally friendly, but flammable. It does not damage the ozone layer, nor does it increase the greenhouse effect.
- During transportation and installation, ensure that the tubing of the refrigerant circuit is not damaged.
- Leaking refrigerant can ignite and may damage the eyes.
- In the event any damage does occur, avoid exposure to open fires and any device which creates a spark. Disconnect the appliance from the mains power.
- Thoroughly ventilate the room in which the appliance is located for several minutes.
- Notify your local authorised service agent for necessary action and advice.
In Queensland contact:
Endeavour Refrigeration
Tel - 07 3137 3622
Kerrs Electrical and Refrigeration
Tel - 07 5491 2188
In all other states:
Go to the De'Longhi Service Locator on our website in the Support Section.
- The room for installing the appliance must be at least 1 cubic metre per 8 grams of refrigerant. The refrigerant quantity contained in this appliance is noted on the Rating Plate of the appliance.
- It is hazardous for anyone other than an Authorised Service Person to service this appliance. In Queensland - the authorised Service Person MUST hold a Gas Work Authorisation for hydrocarbon refrigerants, to carry out Servicing or repairs which involve the removal of covers.

Inbuilt Wine Cabinet does not operate

- Not plugged in.
- The appliance is turned off.
- The circuit breaker tripped or a blown fuse.

Inbuilt Wine Cabinet is not cold enough

- Check the temperature control setting.
- External environment may require a higher setting.
- The door is opened too often.
- The door is not closed completely.
- The door gasket does not seal properly.

Turns on and off frequently

- The room temperature is hotter than normal.
- A large amount of contents has been added to the Inbuilt Wine Cabinet.
- The door is opened too often.
- The door is not closed completely.
- The temperature control is not set correctly.
- The door gasket does not seal properly.

The light does not work

- Not plugged in.
- The circuit breaker tripped or a blown fuse.
- The light button is "OFF".

Vibrations

- Check to assure that the Inbuilt Wine Cabinet is level.

The Inbuilt Wine Cabinet seems to make too much noise.

- The rattling noise may come from the flow of the refrigerant, which is normal.
- As each cycle ends, you may hear gurgling sounds caused by the flow of refrigerant in your Inbuilt Wine Cabinet.
- The Inbuilt Wine Cabinet is not level.

The door will not close properly.

- The Inbuilt Wine Cabinet is not level.
- The door was reversed and not properly installed.
- The gasket is dirty.
- The shelves are out of position.

Consumer Help

If you have any concerns or questions regarding the performance or use of your appliance, please visit:
www.delonghi.com.au
or
www.delonghi.co.nz

Australia

Phone: 1800 126 659
Fax: 1800 007 289

New Zealand

Phone: 0508 200 300
Fax: 0508 200 301

LED Light isn't working

- If the LED light inside your Wine Cabinet stops working, call your local service centre.

Cleaning your Inbuilt Wine Cabinet

- Turn off the power, unplug the appliance, and remove all items including shelves and racks.
- Wash the inside surfaces with a warm water and baking soda solution. The solution should be about 2 tablespoons of baking soda to a quart of water.
- Wash the shelves with a mild detergent solution.
- Wring excess water out of the sponge or cloth when cleaning area of the controls, or any electrical parts.
- Wash the outside cabinet with warm water and mild liquid detergent. Rinse well and wipe dry with a clean soft cloth.
- Do not use steel wool or steel brush on the stainless steel. These will contaminate the stainless steel with steel particles and rusting may occur.

Power Failure

Most power failures are corrected within a few hours and should not affect the temperature of your appliance if you minimise the number of times the door is opened.

If the power is going to be off for a longer period of time, you need to take the proper steps to protect your contents.

Vacation Time

- Short Vacations: Leave the Wine Chiller operating during vacations of less than three weeks.
- Long Vacations: If the appliance will not be used for several months, remove all items and turn off the appliance. Clean and dry the interior thoroughly. To prevent odor and mold growth, leave the door open slightly: blocking it open if necessary.

Moving your Inbuilt Wine Cabinet

- Remove all items.
- Securely tape down all loose items (shelves) inside your appliance.
- Turn the adjustable leg up to the base to avoid damage.
- Tape the door shut.
- Be sure the appliance stays secure in the upright position during transportation. Also protect outside of appliance with a blanket, or similar item.

Energy Saving Tips

The Inbuilt Wine Cabinet should be located in the coolest area of the room, away from heat producing appliances, and out of the direct sunlight.

Disposal

This wine chiller should be disposed appropriately, take the wine chiller to a recycling plant for flammable refrigerant and insulation blowing gasses.

⚠ WARNING ⚠

FOLLOW WARNINGS BELOW ONLY WHEN APPLICABLE TO YOUR MODEL

- Use two or more people to move and install appliance. Failure to do so can result in back or other injury.
- To ensure proper ventilation for your appliance, the front of the unit must be completely unobstructed. Choose a well-ventilated area with temperatures above 60°F (16°C) and below 90°F (32°C). This unit must be installed in an area protected from the element, such as wind, rain, water spray or drips.
- The appliance should not be located next to ovens, grills or other sources of high heat.
- The appliance must be installed with all electrical, water and drain connections in accordance with state and local codes. A standard electrical supply (240V AC only, 50 Hz), properly grounded in accordance with the local codes and regulations.
- Do not kink or pinch the power supply cord of appliance.
- The fuse (or circuit breaker) size should be 10 amperes.
- It is important for the appliance to be levelled in order to work properly. You may need to make several adjustments to level it.
- Never allow children to operate, play with or crawl inside the appliance.
- Do not use solvent-based cleaning agents of abrasives on the interior. These cleaners may damage or discolour the interior.
- Do not use this apparatus for other than its intended purpose of storing beverages.

- Keep ventilation openings, in the appliance enclosure or in the built-in structure, clear of obstruction.
- Do not use mechanical devices or other means to accelerate the defrosting process, other than those recommended by the manufacturer.
- Do not damage the refrigerant circuit.
- Do not use electrical appliances inside the food storage compartments of the appliance, unless they are of the type recommended by the manufacturer.
- WARNING: To avoid a hazard due to instability of the appliance, it must be fixed in accordance with the instructions.
- This appliance is intended to be used in household and similar applications such as:
 - staff kitchen areas in shops, offices and other working environments;
 - farm houses and by clients in hotels, motels and other residential type environments;
 - bed and breakfast type environments;
 - Catering and similar non-retail applications.
- This wine chiller contains flammable refrigerant (R600a; Isobutane and insulation blowing gas) observe the following rules to prevent ignition and explosion:
 - If the wine chiller system should get punctured, do not touch the wall outlet and do not use open flames. Open the window and air out the room.

Electrical Connection

- This appliance should be properly grounded for your safety. The power cord of this appliance is equipped with a three-prong plug which mates with standard three prong wall outlets to minimise the possibility of electrical shock.
- Do not under any circumstances cut or remove the third ground prong from the power cord supplied. For personal safety, this appliance must be properly grounded.
- This appliance requires a standard 240 Volt AC ~/50Hz electrical ground outlet with three-prong. Have the wall outlet and circuit checked by a qualified electrician to make sure the outlet is properly grounded. When a standard 2-prong wall outlet is encountered, it is your responsibility and obligation to have it replaced with a properly grounded 3-prong wall outlet.
- The cord should be secured behind the appliance and not left exposed or dangling to prevent accidental injury.
- The appliance should always be plugged into its own individual electrical outlet which has a voltage rating that matches the rating label on the appliance. This provides the best performance and also prevent overloading house wiring circuits that could cause a fire hazard from overheated. Never unplug the appliance by pulling the power cord. Always grip the plug firmly and pull straight out from the receptacle. Repair or replace immediately all power cords that have become frayed or otherwise damaged. Do not use a cord that shows cracks or abrasion damage along its length or at either end. When moving the appliance, be careful not to damage the power cord.

Extension Cord

- Because of potential safety hazards under certain conditions, it is strongly recommended that you do not use an extension cord with this appliance. However, if you must use an extension cord it must be checked and tested by a qualified technician or service person.

The extension cord must be a VDE-Listed, 3-wire grounding extension cord that has a grounding plug and outlet and that the electrical rating of the cord is 220-240 Volts and at least 10 amperes.

⚠ WARNING ⚠

- To prevent damaging the door gasket, make sure to have the door fully open when pulling shelves out of the rail compartment.
- The appliance must be positioned so that the plug is accessible. Release the electric cord. Move your cabinet to its final location. Do not move your Cabinet while loaded with wine. You might distort the body. The wine cooler should be installed in a suitable place in order to avoid touching the compressor with the hand.
- If the supply cord is damaged, it must be replaced by manufacturer of its Service agent or a similarly qualified person in order to avoid a hazard.

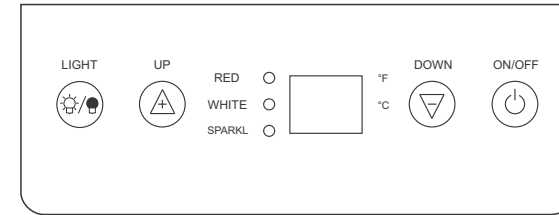

- The Inbuilt Wine Cabinet should be used where there is an ambient temperature above 60°F (16°C) and below 90°F (32°C). If the ambient temperature is out of this range, the performance of the unit may be affected. For example, placing your unit in extreme cold or hot conditions may cause interior temperatures to fluctuate and the operating range of 40-65 degrees Fahrenheit (5-18°C) may not be reached.

ON/OFF Power

- To turn the appliance ON or OFF, press and hold the ON/OFF button for 3 seconds.

Setting the Temperature Control

- You can set the temperature as you desire by touching the UP or DOWN arrow buttons. When you touch the two buttons for the first time, the LED readout will show the original temperature set at previous time (the temperature preset at the factory is 12°C).
- The temperature that you desire to set will increase 1°C if you touch the UP button once, on the contrary the temperature will decrease 1°C if you touch the DOWN button once.
- When you store mostly red wines, the temperature which you control by touching the above two marks need to be set at between 15-18°C and the LED lamp under "RED" will be lit red.

- When you store mostly white wines, the temperature needs to be set at between 9-14°C and the LED lamp under "WHITE" will be lit green.
- When you store mostly sparkling wines, the temperature needs to be set at between 5-8°C and the LED lamp under "SPARKL" will be lit amber.

Interior Light

- You can turn the interior light ON or OFF by touching the LIGHT button.

NOTE:

- If the unit is unplugged, power lost, or turned off, you must wait 3 to 5 minutes before restarting the unit. If you attempt to restart before this time delay, the Inbuilt Wine Cabinet will not start.
- When you use the Inbuilt Wine Cabinet for the first time or restart the Inbuilt Wine Cabinet after having been shut off for a long time, there could be a few degrees variance between the temperature you select and the one indicated on the LED readout. This is normal and it is due to the length of the activation time. Once the Inbuilt Wine Cabinet is running for a few hours everything will be back to normal.

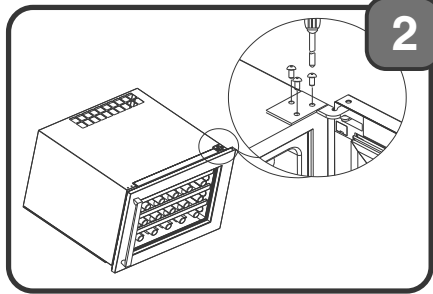

2

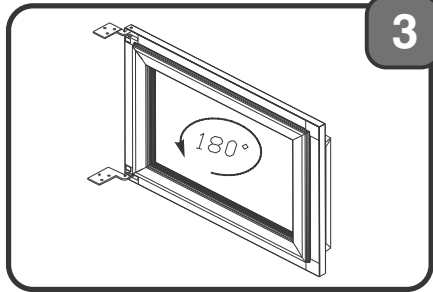

3

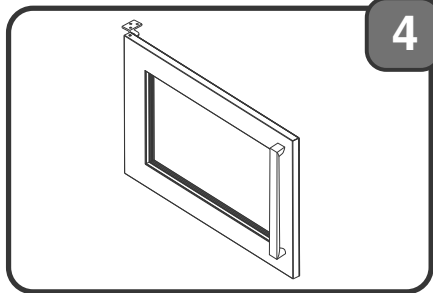

4

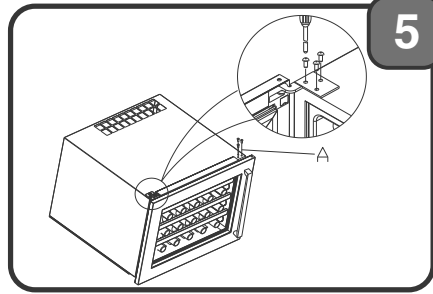

5

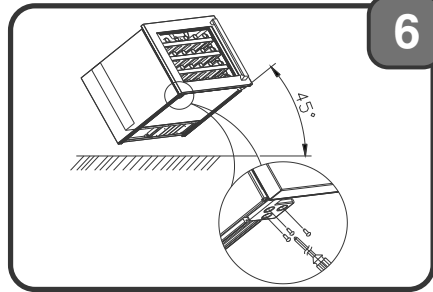

6

⚠ WARNING ⚠

To reduce the risk of fire, electrical shock, or injury when using your appliance, follow these basic precautions:

- Read all instructions before using the Inbuilt Wine Cabinet.
- **DANGER or WARNING:** Risk of child entrapment.

Child entrapment and suffocation are not problems of the past. Junked or abandoned appliances are still dangerous . . . even if they will “just sit in the garage a few days”.

- **Before you throw away your old Inbuilt Wine Cabinet:** Take off the door. Leave the shelves in place so that children may not easily climb inside.
- Never allow children to operate, play with, or crawl inside the appliance.
- Never clean appliance parts with flammable fluids. The fumes can create a fire hazard or explosion.
- Do not store or use gasoline or any other flammable vapors and liquids in the vicinity of this or any other appliance. The fumes can create a fire hazard or explosion.

Before using your Inbuilt Wine Cabinet

- Remove the exterior and interior packing.
- Before connecting the Inbuilt Wine Cabinet to the power source, let it stand upright for approximately 2 hours. This will reduce the possibility of a malfunction in the cooling system from handling during transportation.
- Clean the interior surface with lukewarm water using a soft cloth.

- Install the handle on the left side of the door.
- When replacing the illuminating lamp, purchase a lamp which complies with the rated power input of the existing lamp according to the rating label. Shut off the power supply before replacing the lamp.
- When disposing of your appliance, please choose an authorised disposal site in your local area.

Installation of your Inbuilt Wine Cabinet

- This appliance is designed for an inbuilt installation (fully recessed).
- Place your Inbuilt Wine Cabinet on a floor that is strong enough to support it when it is fully loaded. To level your Inbuilt Wine Cabinet, adjust the front levelling legs at the bottom of the Inbuilt Wine Cabinet.
- Locate the Inbuilt Wine Cabinet away from direct sunlight and sources of heat (stove, heater, radiator, etc.). Direct sunlight may affect the acrylic coating and heat sources may increase electrical consumption. Extreme cold ambient temperatures may also cause the unit not to perform properly.
- Avoid locating the unit in moist areas.
- Plug the Inbuilt Wine Cabinet into an exclusive, properly installed-grounded wall outlet. Do not under any circumstances cut or remove the third (ground) prong from the power cord. Any questions concerning power and/or grounding should be directed toward a certified electrician or an authorised service center.

Clearances

- This unit is designed for built-in installation only. If you plan to use this unit in a built-in application please follow the requirements below.
- NOTE: You will need to install the Inbuilt Wine Cabinet with a lower ventilation grill providing 200cm² of ventilation. This is not supplied with the unit and must be purchased separately.

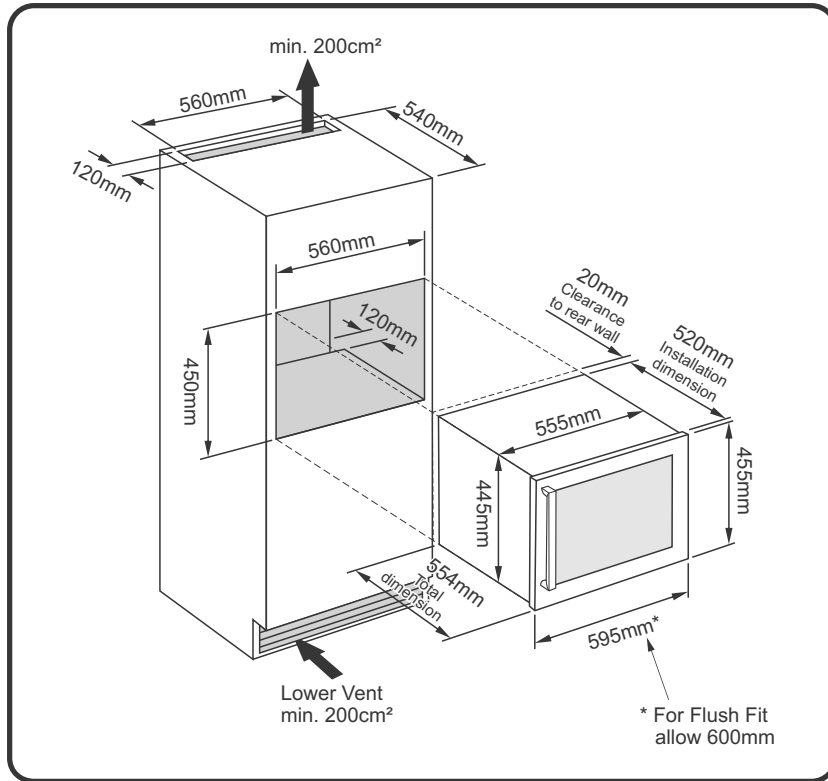

Fixing into the cabinet

- After installing the inbuilt wine cabinet into the cabinet structure, adjust the fixing strip (a) so it is close to the cabinet (b)
- Then fix the 3 screws through the fixing strip (a) and screw into the cabinet (b)

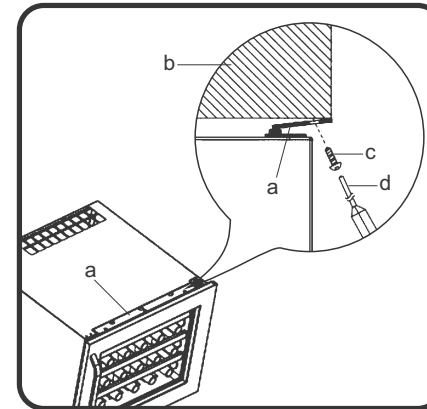

- a) Fixing Strip
- b) Cabinet
- c) Screw
- d) Screwdriver

How to remove the shelf

When removing any of these wire shelves out of the rail compartment, To fit or remove the shelf, tilt the shelf as per the diagram and simply pull out, or push in the shelf until it sits on the support brackets securely.

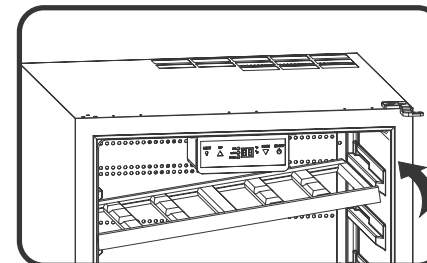

Reversing the Door Swing of Your Appliance

This appliance has the capability of the door opening from either the left or right side. The unit is delivered with a right hinged door.

If you wish to reverse the hinge on your appliance, follow these instructions:

- Incline the wine cabinet backwards to a 45 degree angle, take out the right lower hinge screws with a screwdriver (Fig.1).
- Level the wine cabinet, hold the door and take out right upper hinge screws with a screwdriver. Then take out the door and rotate door 180 degrees (See Fig.2, Fig.3 & Fig.4 on Page 12).
- Take off the decorative caps from the left upper side, then position the hinge and fix the screws to the left upper side. Fit the decorative caps to the right upper side, Location 'A' (see Fig.5 on Page 12).
- Incline the wine cabinet backwards to a 45 degree angle and fix the lower left screws. (see Fig.6 on Page 12).
- Level the wine cabinet and check that the door opens and closes freely.

